

COMMONLY SERVICED COMPONENTS

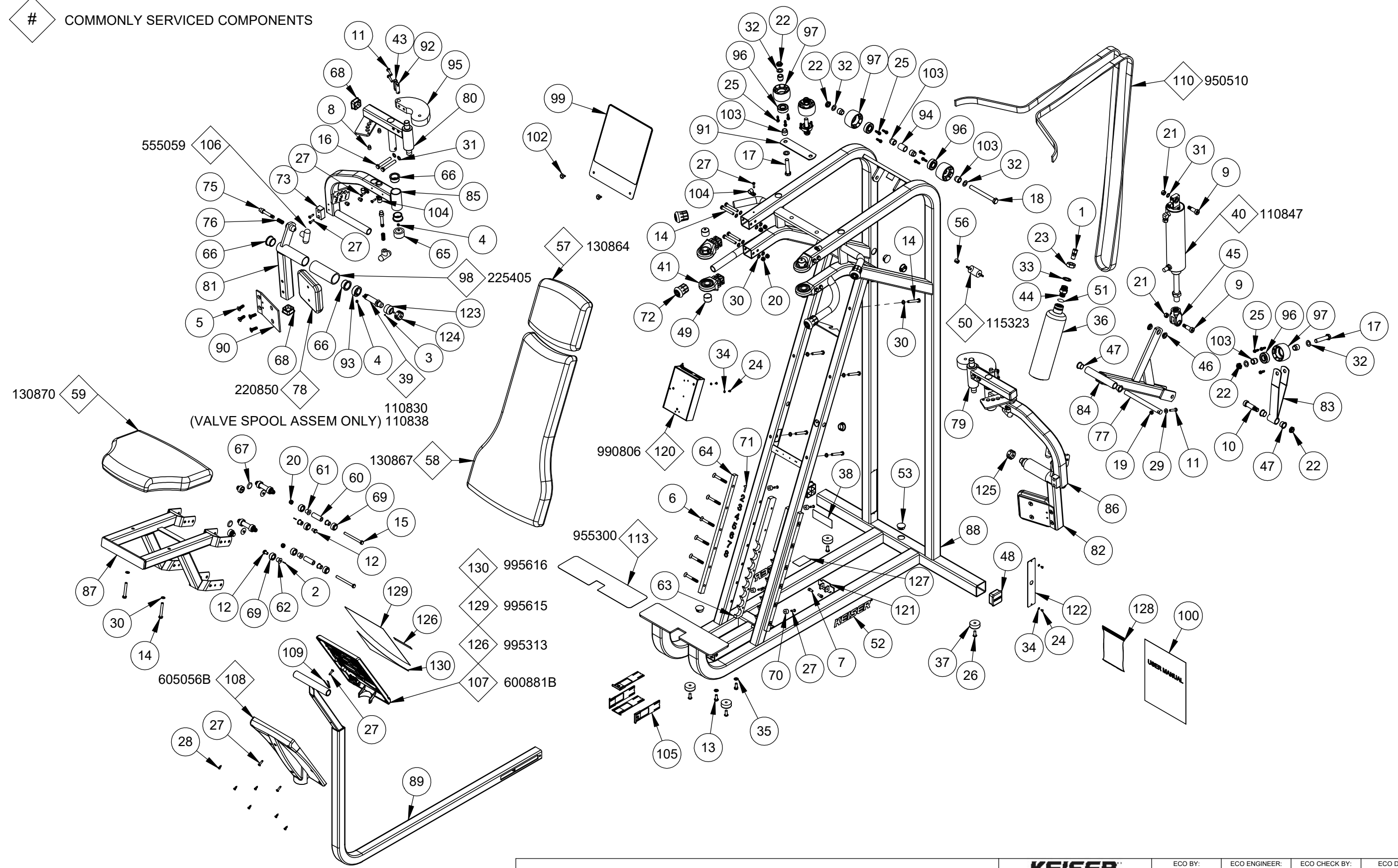

NOTE:
THIS DRAWING COVERS: 2235BP & 2235SP

<p>KEISER 2470 South Cherry Ave. Fresno, CA USA 93705-5004 Phone: (559) 256-8000 Fax: (559) 256-8100 THE INFORMATION DISCLOSED HEREIN WAS ORIGINATED BY AND IS THE PROPERTY OF KEISER CORP. AND ALL PATENT, PROPRIETARY DESIGN, USE, SALE, MANUFACTURING, AND REPRODUCTION RIGHTS THERE TO ARE RESERVED BY KEISER CORP.</p>		ECO BY: AL	ECO ENGINEER: LC	ECO CHECK BY: LC	ECO DATE: 5/4/26	ECO: 4178	
<p>REV: C REFERENCE WM BOM REV E</p>		PROJECT ENGINEER: CHIEF ENGINEER		DRAWN BY: BJU		ORIGINATION DATE: 8/20/21	
		MATERIAL:				MATERIAL #:	
		TITLE: A350 SEATED BUTTERFLY - SA				PART #: 2235XP-SA	REV: C

ITEM NO.	QTY.	PART NO.	TITLE	ITEM NO.	QTY.	PART NO.	TITLE	ITEM NO.	QTY.	PART NO.	TITLE
1	1	8079	CON - 3/8C X 1/4M	64	2	135006	SEAT RAIL	120	1	990806	ASSY - PROCESSOR BOX
2	4	9009	PIN - SPRING 1/16 X 1/2	65	2	135049	CAP - Ø1 ID	121	1	990959	END CAP - DISPLAY TUBE
3	4	9014	SCREW - HSSS 8-32 X 1/8 SS	66	8	135050	BEARING - FLANGE-1" ID	122	1	992074	PLATE - COVER-POWER ENTRY
4	4	9026	SCREW - HSSS 5/16-18 X 1/4 ZP	67	4	135055	STEM BUMPER	123	2	995001	CAP - GRIP W HOLE
5	8	9075	SCREW - SFCCHCS 5/16-18 X 1 ZP	68	4	135056	CAP - 1.500 SQ-PL	124	1	995300	DECAL - TB-PLUS
6	12	9079	SCREW - SFCCHCS 5/16-18 X2 1/2	69	12	135060	ROLLER	125	1	995301	DECAL - TB-MINUS
7	2	9098	SCREW - SHCS 1/4-20 X 1/2 ZP	70	4	135076	PLASTIC BUMPER	126	1	995313	DECAL - SEAT, ARM, ROM-POWER
8	8	9104	SCREW - SHCS 5/16-18 X 1/4 ZP	71	1	135306	DECAL - SEAT-1-10	127	1	995324	DECAL - MADE IN THE USA
9	2	9127	SCREW - SHSS 1/2 X 1 ZP	72	4	135422	RUBBER CRUTCH TIP #20 BLK	128	1	995418	BAG - 4 X 6 X 4MIL-ZIP LOCK
10	1	9131	SCREW - SHSS 5/8 X 1-1/2 ZP	73	2	165421	STOP - EA-URETHANE	129	1	995615	PLACARD - ENG-POWER-BLK
11	5	9154	SCREW - HHCS 1/4-20 X 1-1/4 ZP	74	1	170891	ASSY - MUFFLER-LONG	130	1	995616	PLACARD - ENG-KEY-RED
12	4	9174	SCREW - HHCS 5/16-18 X 1/2 ZP	75	4	172180	PLUNGER				
13	2	9175	SCREW - HHCS 5/16-18 X 3/4 ZP	76	4	175500	SPRING - PLUNGER				
14	16	9179	SCREW - HHCS 5/16-18 X 2-1/4 ZP	77	1	212180	PIVOT SHAFT				
15	4	9183	SCREW - HHCS 5/16-18 X 3-1/2 ZP	78	2	220850	ARM CUSHION				
16	4	9207	SCREW - HHCS 3/8-16 X 2-1/2 ZP	79	1	220920	L ADJUST ARM				
17	3	9214	SCREW - HHCS 1/2-13 X 2-1/2 ZP	80	1	220921	R ADJUST ARM				
18	1	9217	SCREW - HHCS 1/2-13 X 5 ZP	81	1	220922	R EX ARM - BOTTOM				
19	1	9225	NUT - HELN 1/4-20 ZP	82	1	220923	L EX ARM - BOTTOM				
20	12	9226	NUT - HELN 5/16-18 ZP	83	1	220924	IDLER MOUNT				
21	2	9227	NUT - HRLN 3/8-16 ZP	84	1	220926	LEVER ARM				
22	5	9230	NUT - HEJN 1/2-13 ZP	85	1	220930	R EX ARM - TOP				
23	1	9231	NUT - HJN 3/4-10 ZP	86	1	220931	L EX ARM - TOP				
24	4	9255	SCREW - CRPHMS 6-32 X 1/4 ZP	87	1	220933	WELDT - FRAME-SEAT				
25	15	9270	SCREW - HWHTS #12-24 X 3/4 ZP	88	1	220934	FRAME - MAIN-A400				
26	4	9279	SCREW - SBHTS-TF 5/16-18 X 3/4 ZP	89	1	220937	DISPLAY MT - CENTER-PWR				
27	17	9285	SCREW - CRPHTS 10-24 X 3/4 ZP	90	2	221000	UPHOLSTREY MT PLATE				
28	6	9291	SCREW - CRPHTS 8 X 1/2 ZP	91	1	221800	BELT GUIDE				
29	1	9349	WASHER - FW-SAE-1/4 ZP	92	2	222160	ROUND BELT CLAMP				
30	24	9353	WASHER - THIN-ACFT 0313 SS	93	2	222350	GRIP COLLAR - 1000 ID				
31	5	9355	WASHER - FW-ACFT-3/8 SS	94	1	223080	SPACER				
32	8	9360	WASHER - ACFT 1/2 SS	95	2	225001	CAM				
33	1	9364	WASHER - ITLW 3/4 ZP	96	5	225400	BEARING - 6203ZZ-SHIELDED				
34	4	9366	WASHER - ITLW #6 ZP	97	5	225401	IDLER				
35	2	9389	WASHER - ITLW 5/16 ZP	98	2	225405	GRIP - 1.43" ID x 4.5" L				
36	1	100903	TANK - 68 IN3	99	1	225416	PLACARD - A350 SEATED BUTTERFLY				
37	4	105423	BUMPER - MOLDED GLIDE	100	1	225501	MANUAL - USER-A350 SEATED BUTTERFLY				
38	1	105443	DECAL - SN-STRENGTH-CE	101	1	265310	Y CONNECTOR - 1/8 DIA-PL				
39	2	110830	ASSY - TB VALVE-DIG	102	2	265404	PLASTIC RIVET				
40	1	110847	ASSY - EC-2.5 X 7	103	10	265422	BUSHING - IDLER				
41	4	110894	BEARING - TUBE MT-0750 ID	104	6	275422	CLAMP - CABLE-0500				
42	1	110897	ASSY - QD-MALE	105	4	505068	BUSHING - 4 PIECE				
43	2	111896	CLAMP W/HOLE	106	4	555059	KNOB - T-BLACK				
44	1	115000	BUSHING - TANK	107	1	600881B	DISPLAY BOX - 5 WIN				
45	1	115005	CLEVIS - CYLINDER-2500	108	1	605056B	DISPLAY BOX - BACK				
46	2	115051	BEARING - FLANGE-0.500 ID	109	1	605428	GROUND CLAMP - DISPLAY				
47	4	115052	BEARING - FLANGE-0.625 ID	110	1	950510	BELT - 1 IN-NEOPRENE				
48	2	115054	PLUG - 2 IN SQ-KEISER	111	1	953101	TUBING - .375 OD X .062 W-PE BLK				
49	4	115067	CAP - Ø1 X 3/4	112	1	953108	TUBING - 1/4 URETHANE BLK				
50	1	115323	FILTER - IN LINE	113	1	955300	STRIP - PROTECTOR-4 INCH				
51	1	115333	O-RING - .943 X .737 X .103	114	2	962004	CON - 2MM-2-S				
52	2	115372	DECAL - KEISER LOGO-1 1/4" RED	115	6	962005	CON - MOD - P-4P-4C				
53	5	115404	PLUG - HOLE-1 DIA	116	1	962016	CON - MOD-COUPLER-6-6				
54	16	115423	TIE - 8 IN-PL BLK	117	4	962017	CON-MOD-P-6P-6C				
55	1	115429	PLASTIC TIE - 10" RED	118	1	966701	WIRE - CABLE-4-26 GA				
56	1	120803	FLOW RESTRICTOR	119	1	966702	WIRE - CABLE-6-26 GA				
57	1	130864	CUSHION - HEAD-CURVED								
58	1	130867	CUSHION - BACK-CURVED								
59	1	130870	CUSHION - SEAT-CURVED								
60	4	132181	TUBE - ROLLER								
61	8	132200	AXLE								
62	4	132201	AXLE - THREADED								
63	2	135005	SEAT RACK								

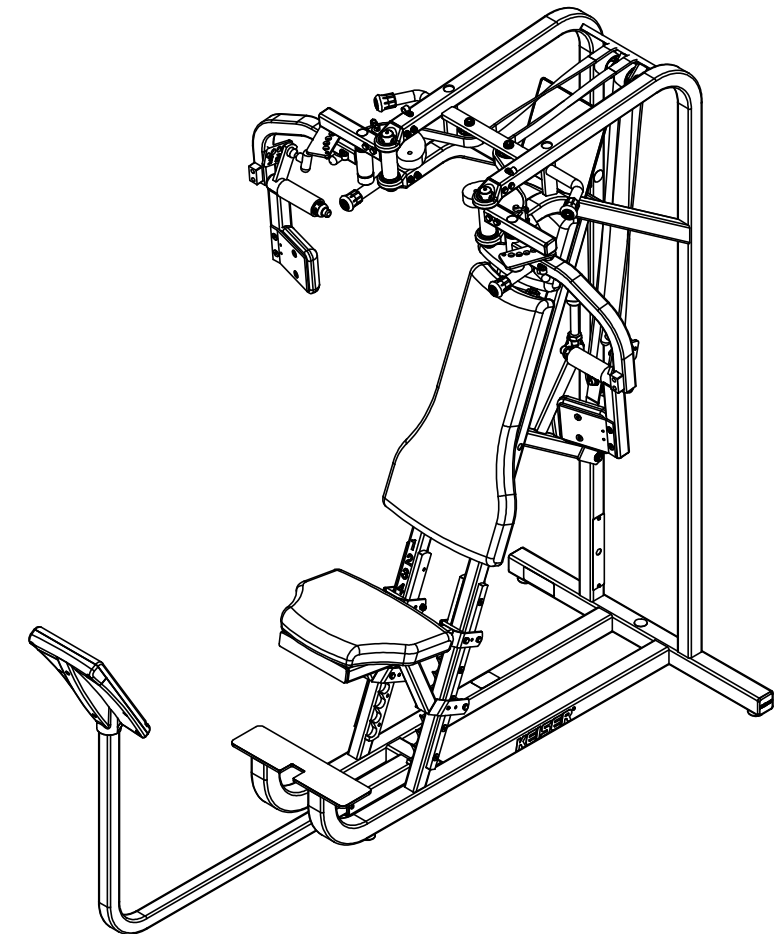

SHEET: 2 OF 2 SIZE: B SCALE: 1:18 (DO NOT SCALE DRAWING) LAST SAVED: 5/4/2026

KEISER

2470 South Cherry Ave. Phone: (559) 256-8000
 Fresno, CA USA 93705-5004 Fax: (559) 256-8100
 THE INFORMATION DISCLOSED HEREIN WAS ORIGINATED BY AND IS THE PROPERTY OF KEISER CORP. AND ALL PATENT, PROPRIETARY DESIGN, USE, SALE, MANUFACTURING, AND REPRODUCTION RIGHTS THERE TO ARE RESERVED BY KEISER CORP.

DIMENSIONS ARE IN INCHES
 DIMENSIONS IN [] ARE MILLIMETERS
 BREAK SHARP EDGES .005-.015 [.10-.40]
 MACHINED SURFACE FINISH IS
 63 MICROINCHES [1.6 MICROMETERS]

ECO BY:	ECO ENGINEER:	ECO CHECK BY:	ECO DATE:	ECO:
AL	LC	LC	5/4/26	4178
PROJECT ENGINEER:		DRAWN BY:		ORIGINATION DATE:
CHIEF ENGINEER		BJU		8/20/21
MATERIAL:				MATERIAL #:
TITLE:				PART #:
A350 SEATED BUTTERFLY - SA				2235XP-SA
				REV:
				C

REV: C REFERENCE WM BOM REV E

ITEM NO.	QTY.	PART NO.	TITLE	ITEM NO.	QTY.	PART NO.	TITLE
1	1	8079	CON - 3/8C X 1/4M	64	8	135050	BEARING - FLANGE-1" ID
2	4	9009	PIN SPRING 0063 X 0500 ZP	65	4	135055	STEM BUMPER
3	4	9014	SCREW - HSSS 8-32 X 1/8 SS	66	4	135056	CAP - 1.500 SQ-PL
4	4	9026	SCREW - HSSS 5/16-18 X 1/4 ZP	67	12	135060	ROLLER
5	8	9075	SCREW - SFCHCS 5/16-18 X 1 ZP	68	4	135076	PLASTIC BUMPER
6	12	9079	SCREW - SFCHCS 5/16-18 X2 1/2	69	1	135306	DECAL - SEAT-1-10
7	8	9104	SCREW - SHCS 5/16-18 X 1/4 ZP	70	4	135422	RUBBER CRUTCH TIP - #20 BLK
8	2	9127	SCREW - SHSS 1/2 X 1 ZP	71	1	135426	FILTER CLIP
9	1	9131	SCREW - SHSS 5/8 X 1-1/2 ZP	72	2	165421	STOP - EA-URETHANE
10	5	9154	SCREW - HHCS 1/4-20 X 1-1/4 ZP	73	1	170891	ASSY - MUFFLER-LONG
11	4	9174	SCREW - HHCS 5/16-18 X 1/2 ZP	74	4	172180	PLUNGER
12	2	9176	SCREW - HHCS 5/16-18 X 1 ZP	75	1	175051	2 SQ. BUSHING
13	16	9179	SCREW - HHCS 5/16-18 X 2-1/4 ZP	76	4	175500	SPRING - PLUNGER
14	4	9183	SCREW - HHCS 5/16-18 X 3-1/2 ZP	77	1	212180	PIVOT SHAFT
15	4	9207	SCREW - HHCS 3/8-16 X 2-1/2 ZP	78	2	220850	ARM CUSHION
16	4	9214	SCREW - HHCS 1/2-13 X 2-1/2 ZP	79	1	220900	MAIN FRAME
17	1	9225	NUT - HELN 1/4-20 ZP	80	1	220920	L ADJUST ARM
18	12	9226	NUT - HELN 5/16-18 ZP	81	1	220921	R ADJUST ARM
19	2	9227	NUT - HRLN 3/8-16 ZP	82	1	220922	R EX ARM - BOTTOM
20	5	9230	NUT - HELN 1/2-13 ZP	83	1	220923	L EX ARM - BOTTOM
21	1	9231	NUT - HJN 3/4-10 ZP	84	1	220924	IDLER MOUNT
22	15	9270	SCREW - HWHTS #12-24 X 3/4 ZP	85	1	220926	LEVER ARM
23	2	9272	SCREW - CRPHTS-TF #6-32 X 1/2 SS	86	1	220930	R EX ARM - TOP
24	4	9279	SCREW - SBHTS-TF 5/16-18 X 3/4 ZP	87	1	220931	L EX ARM - TOP
25	18	9285	SCREW - CRPHTS 10-24 X 3/4 ZP	88	1	220932	WELDT - DISPLAY MT-CS
26	6	9291	SCREW - CRPHTS 8 X 1/2 ZP	89	1	220933	WELDT - FRAME-SEAT
27	1	9349	WASHER - FW-SAE-1/4 ZP	90	2	221000	UPHOLSTREY MT PLATE
28	24	9353	WASHER - ACFT-5/16 ZP	91	1	221800	BELT GUIDE
29	5	9355	WASHER - FW-ACFT-3/8 SS	92	2	222160	ROUND BELT CLAMP
30	8	9360	WASHER - ACFT 1/2 SS	93	2	222350	GRIP COLLAR - 1000 ID
31	1	9364	WASHER - ITLW 3/4 ZP	94	1	223080	SPACER
32	2	9366	WASHER - ITLW #6 ZP	95	2	225001	CAM
33	2	9389	WASHER - ITLW 5/16 ZP	96	5	225400	BEARING - 6203ZZ-SHIELDED
34	1	100903	TANK - 72 IN3	97	5	225401	IDLER
35	4	105423	BUMPER - MOLDED GLIDE	98	2	225405	GRIP - 1.43" ID x 4.5" L
36	1	105443	DECAL - SERIAL NUMBER	99	1	225416	PLACARD - A350 SEATED BUTTERFLY
37	2	110830	ASSY - TB VALVE-DIG	100	1	265310	Y CONNECTOR - 1/8 DIA-PL
38	1	110847	ASSY - EC-2.5 X 7	101	2	265404	PLASTIC RIVET
39	4	110894	BEARING ASSY	102	10	265422	BUSHING - IDLER
40	1	110897	ASSY - QD-MALE	103	6	275422	CLAMP - CABLE-0500
41	2	111896	CLAMP W/HOLE	104	4	555059	KNOB - T-BLACK
42	1	115000	BUSHING - TANK	105	1	600881X	DISPLAY BOX - 5 WIN
43	1	115005	CLEVIS - CYLINDER-2-1/2	106	1	605056	DISPLAY BOX - BACK
44	2	115051	BEARING - FLANGE-.5 ID	107	1	605428	GROUND CLAMP - DISPLAY
45	4	115052	BEARING - FLANGE-.625 ID	108	1	950510	KEVLAR BELT - FORMED
46	3	115054	PLUG - 2 IN SQ-KEISER	109	1	953101	TUBING - .375 OD X .062 W-PE BLK
47	4	115067	CAP - Ø1 X 3/4	110	1	953108	TUBING - 1/4 URETHANE BLK
48	1	115323	FILTER - IN LINE	111	1	955300	STRIP - PROTECTOR-4 INCH
49	1	115333	O-RING - .943 X .737 X .103	112	2	962004	CON - 2MM-2-S
50	2	115372	DECAL - KEISER LOGO-1 1/4" RED	113	6	962005	CON - MOD - P-4P-4C
51	2	115404	PLUG - HOLE-1 DIA	114	1	962016	CON - MOD-COUPLER-6-6
52	16	115423	TIE - 8 IN-PL BLK	115	4	962017	CON-MOD-P-6P-6C
53	1	115429	PLASTIC TIE - 10" RED	116	1	966701	WIRE - CABLE-4-26 GA
54	1	120803	FLOW RESTRICTOR	117	1	966702	WIRE - CABLE-6-26GA
55	1	130864	CUSHION - HEAD-CURVED	118	1	990806	ASSY - PROCESSOR BOX
56	1	130867	CUSHION - BACK-CURVED				
57	1	130870	CUSHION - SEAT-CURVED				
58	4	132181	TUBE - ROLLER				
59	8	132200	AXLE				
60	4	132201	AXLE - THREADED				
61	2	135005	SEAT - RACK				
62	2	135006	SEAT - RAIL				
63	2	135049	CAP - Ø1 ID				

2235XP-SA

ITEM NO.	QTY.	PART NO.	TITLE
119	3	990812	KEY - DATA-CS
120	2	995001	CAP - GRIP W HOLE
121	1	995300	DECAL - TB-PLUS
122	1	995301	DECAL - TB-MINUS
123	1	995313	DECAL - SEAT, ARM, ROM-POWER
124	1	995324	DECAL - MADE IN THE USA
125	1	995418	BAG - 4 X 6 X 4MIL-ZIP LOCK
126	1	995615	PLACARD - ENG-POWER-BLK
127	1	995616	PLACARD - ENG-KEY-RED

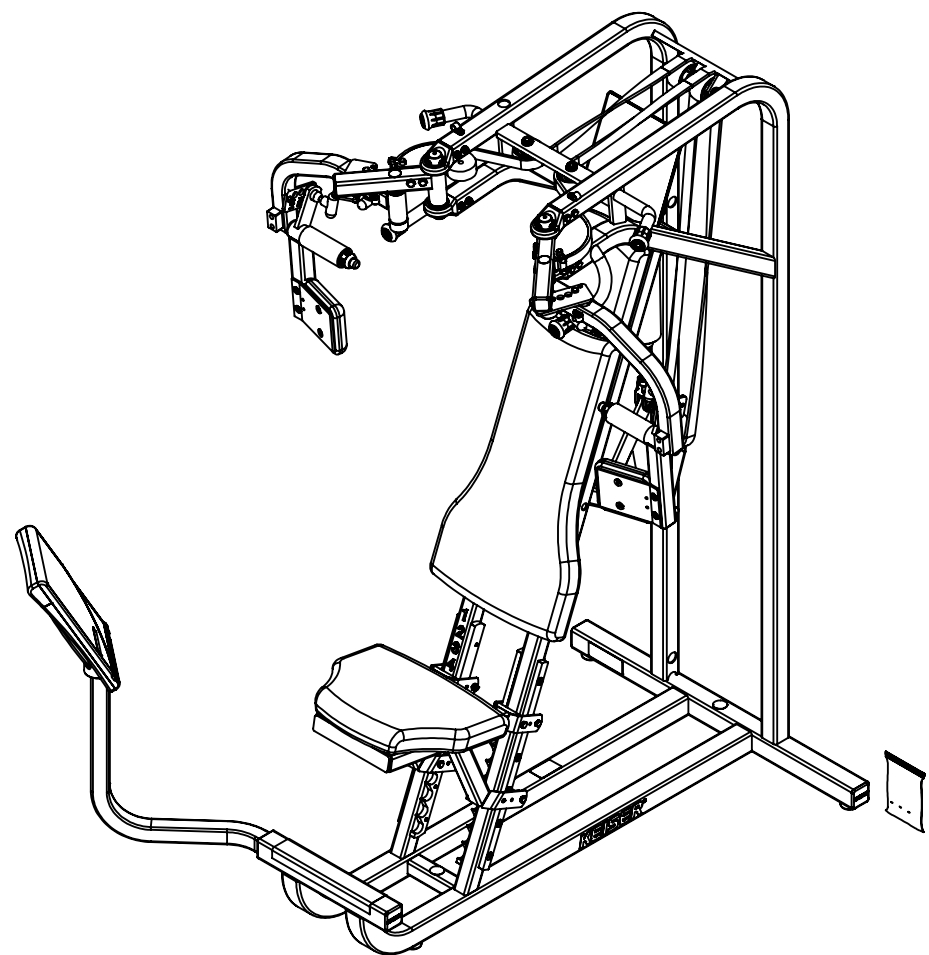

PRINTED ON: 8/20/2021 SW2006 V5.1 X:\drawings_REVISION\22_BUTTERFLY

KEISER®

2470 South Cherry Ave. Phone: (559) 256-8000
 Fresno, CA, USA 93706-5004 Fax: (559) 256-8100

THE INFORMATION DISCLOSED HEREIN WAS ORIGINATED BY AND IS THE PROPERTY OF KEISER CORP. AND ALL PATENT, PROPRIETARY, DESIGN, USE, SALE, MANUFACTURING, AND REPRODUCTION RIGHTS THERETO ARE RESERVED BY KEISER CORP.

DIMENSIONS ARE IN INCHES
 DIMENSIONS IN [] ARE MILLIMETERS
 BREAK SHARP EDGES .005-.015 (.10-.40)
 MACHINED SURFACE FINISH IS
 63 MICROINCHES [1.6 MICROMETERS]
 DO NOT SCALE DRAWING

DRAWN BY: BJU	DATE DRAWN: 6/23/21	CHECKED BY: LC	DATE CHECKED: 8/20/21
---------------	---------------------	----------------	-----------------------

MATERIAL:
 RAW MAT: MASS (Kg):

REV	ECO	REVISION DESCRIPTION	BY	CKD	DATE
A	3921	REFERENCE ECO MEMO FOR DETAILS	BJU	LC	8/20/21

TITLE: **A350 SEATED BUTTERFLY - PWR - SA**
 SHEET **2** OF **2** SCALE: **1:16** DRAWING SIZE: **B** PART#: **2235XP-SA**