



LOWER BACK

MODELS: 002821BP, 002821SP

OPERATION MANUAL

Notice: Legacy Model Applicability

This manual also covers legacy Lower Back models 002821BP/002821SP with side-mounted display manufactured before August 2025. Users should refer to the safety, operation, and care sections, noting adjustments may not apply.

CONTENTS

03 – GENERAL INFORMATION

03_INTRODUCTION

03_REGISTER YOUR PURCHASE

03_SERIAL NUMBER INFORMATION

04 – IMPORTANT SAFETY INFORMATION

05_CONVENTIONS USED

05_SAFETY AND NOTIFICATION LABELS

06_CONTRAINDICATIONS

07 – TECHNICAL SPECIFICATIONS

07_EQUIPMENT SPECIFICATIONS

07_TECHNICAL DATA

08 – INSTALLATION AND PLACEMENT

08_TRAINING SPACE

09 – OPERATION

09_EQUIPMENT OVERVIEW

10_POWER DISPLAY

12_PROPER OPERATION CHECK

13_HOW TO USE THE LOWER BACK

15_POWER TEST

16 – MAINTENANCE

16_PREVENTATIVE MAINTENANCE SCHEDULE

17_BATTERY REPLACEMENT

18_ANNUAL MAINTENANCE

19 – REGULATORY AND COMPLIANCE NOTICES

19_SAFETY NOTIFICATIONS

20_ELECTROMAGNETIC COMPATIBILITY (EMC)

20_US FCC COMPLIANCE STATEMENT

20_DISPOSAL

23 – WARRANTY STATEMENT

Keiser, the Keiser logo, and other trademarks associated with Keiser products referred to in this publication are trademarks of Keiser Corporation.
© 2025 Keiser Corporation. All rights reserved.

Distribution and copying of this document, use and communication of its contents is not permitted without written authorization from Keiser Corporation. The content of this document is furnished for informational use only, may be subject to change without notice, and should not be construed as a commitment by Keiser Corporation. Every effort has been made to ensure that the information in this manual is accurate. Keiser Corporation is not responsible for printing or clerical errors.

GENERAL INFORMATION

INTRODUCTION

Congratulations on the purchase of your new Keiser Lower Back machine and welcome to the Keiser family. Keiser's Dynamic Variable Resistance safely builds strength at any speed, which is key to building maximum power.

For your safety, and to ensure the best experience and maximum gains, it is critical that you read and understand this manual before you begin using the Lower Back. If you have any questions regarding the operation of the Lower Back after reading this manual, our Keiser Customer Support team will be happy to assist by telephone at 1 559 256 8000 and via live chat at [keiser.com/support](https://www.keiser.com/support) (Monday–Friday, 7 am to 5:30 pm PST), or by email at service@keiser.com.

Yours in Health,
Keiser Corporation

REGISTER YOUR PURCHASE

Register your Lower Back machine to stay informed of safety notifications and for faster, more accurate warranty service.

Scan the QR Code to the right to access the interactive online warranty registration form or visit:

<https://www.keiser.com/forms/warrantyregistration>



SCAN

SERIAL NUMBER INFORMATION

Please take a moment at this time to record the serial number in the space provided below.

Serial No.: _____

| Serial Number Information | |
|---------------------------|---------------------------------------|
| A | Manufacturer name, logo, and address |
| B | Country of manufacture |
| C | Patent information notification |
| D | WEEE Directive mark |
| E | CE mark |
| F | TÜV SÜD mark |
| G | Unique Device Identification (UDI) |
| H | ISO Accuracy and Usage Classes |
| I | Maximum User Weight Limit |
| J | Medical Device Risk Classification |
| K | European Authorized Representative |
| L | UK Responsible Person |
| M | Serial number and date of manufacture |
| N | Model number and product description |
| O | UK Conformity Assessed mark |

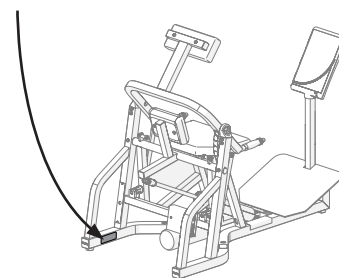
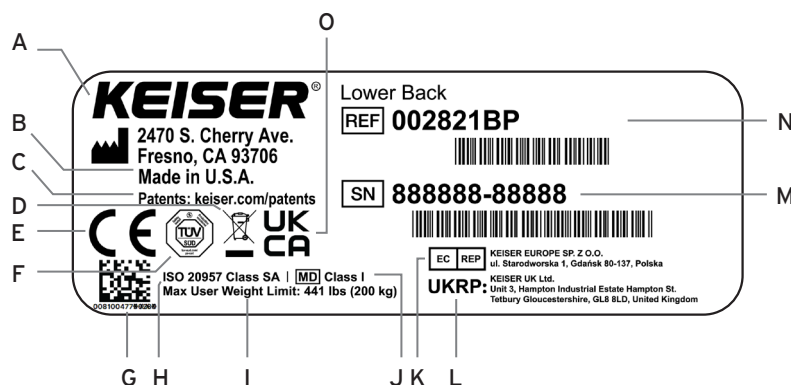



Figure 1. Serial Number Location and Information

Marking plate illustration is for reference only. Refer to the marking plate attached to the equipment for specific product information.

IMPORTANT SAFETY INFORMATION

It is the sole responsibility of the purchaser of Keiser Corporation equipment to instruct all individuals, whether they are the end-user or supervising personnel, on proper usage of the equipment. Keiser Corporation recommends that all users of its equipment be informed of the following information before use.

1.  Read these instructions.
2. Heed all warnings.
3. Follow these instructions.
4. Intended use of the Lower Back is for physical activity or Physiotherapy (sometimes referred to as physical therapy).
5. The Lower Back is intended for individuals aiming to maintain and restore maximum movement and functional ability throughout their lifespan, including circumstances where movement and function are limited by aging, injury, pain, disease, disorders, conditions, or environmental factors, especially in case of using the Lower Back in physical therapy.
6. Consult your physician before beginning any exercise program.
7. The Lower Back is intended for use in training areas of organizations where access and control are specifically regulated by a person responsible for determining the suitability of use and maintenance.
8. Maximum user weight limit: 441 lbs (200 kg).
9. Use the Lower Back indoor in a climate-controlled environment only. Keep away from areas of extreme humidity.
10. The use of this Lower Back for any purpose not explicitly specified by the manufacturer in this manual is prohibited.
11. Wear proper exercise clothing and shoes for exercise. Avoid wearing loose clothing that might catch on any moving parts. Tie long hair back and up away from any moving parts.
12. The Lower Back is not a toy. Children shall not play with the Lower Back. Children under 14 years old should not use the Lower Back. Keep children and pets clear from the Lower Back at all times, especially while in use. Cleaning and user maintenance shall not be performed by children.
13. The Lower Back can be used by children age 14 years and above. Persons with mental disabilities, reduced physical, mental, or sensory capabilities, or lack of experience or knowledge should not use the Lower Back without constant supervision by a spotter/supervisor.
14. Proper warm-up required to help prevent injury. This Lower Back should only be used with proper instructions. Always maintain good form and control during exercise. If you feel pain or are unable to maintain good form, stop immediately. Failure to follow these instructions could result in injury.
15. Always maintain control of the Exercise Arm during exercise. Use extreme caution in the selection of resistance and when increasing resistance during exercise. Bring the Exercise Arm to the start position in a controlled manner to safely end exercise. If at any time you are not able to control the amount of resistance during exercise, push the left ("←") Thumb Button to reduce the resistance.
16. Never perform Power Test without a proper warm-up. This high resistance/high-speed test should only be performed with proper instructions (see page 15 "Power Test" for complete instruction). Always maintain good form and control during the test. If you feel pain or are unable to maintain good form, stop immediately. Failure to follow these instructions could result in injury.
17. The highest level of safety can only be ensured if the equipment is regularly inspected for damage and wear. Always check the equipment before use for proper function and any damaged, worn, or broken parts. Immediately replace damaged, worn, or broken parts. Do not use the Lower Back until all repairs have been completed and tested by a Keiser-certified technician.
18. Use only replacement parts supplied/recommended by Keiser Corporation. Attempting to repair or replace any damaged, worn, or broken parts on your own is not recommended. A Keiser-certified technician should be consulted.
19. The use of any exercise equipment, including, without limitation, Keiser's strength training equipment in which resistance can be changed at any time during the repetition, without proper instruction and supervision violates the terms of the agreement for the purchase of such products. The ability to add resistance anytime during a repetition, including, without limitation, the ability to do a heavy negative may be dangerous, especially for anyone that does not recognize or respect the potential danger.
20. Users, agents, and/or anyone directing the use of the Lower Back shall determine the suitability of the Lower Back for its intended use, and said parties are specifically put on notice that they shall assume all risk and liability in connection herewith.
21. If you do not understand these instructions or have doubts about the safety of the installation, assembly, or use of this product, contact Keiser Customer Support:

 1 559 256 8000 service@keiser.com keiser.com/support

Telephone and Live Chat
Monday–Friday 7 am to 5:30 pm PST

IMPORTANT SAFETY INFORMATION

CONVENTIONS USED

This Operation Manual contains the following marks:

- ⚠ WARNING:** Indicates a hazardous situation that, if not avoided, could result in death or serious injury.
- ⚠ CAUTION:** Indicates a hazardous situation that, if not avoided, could result in minor or moderate injury.
- ❗ IMPORTANT:** Indicates information considered critical, but not hazard-related.

SAFETY AND NOTIFICATION LABELS

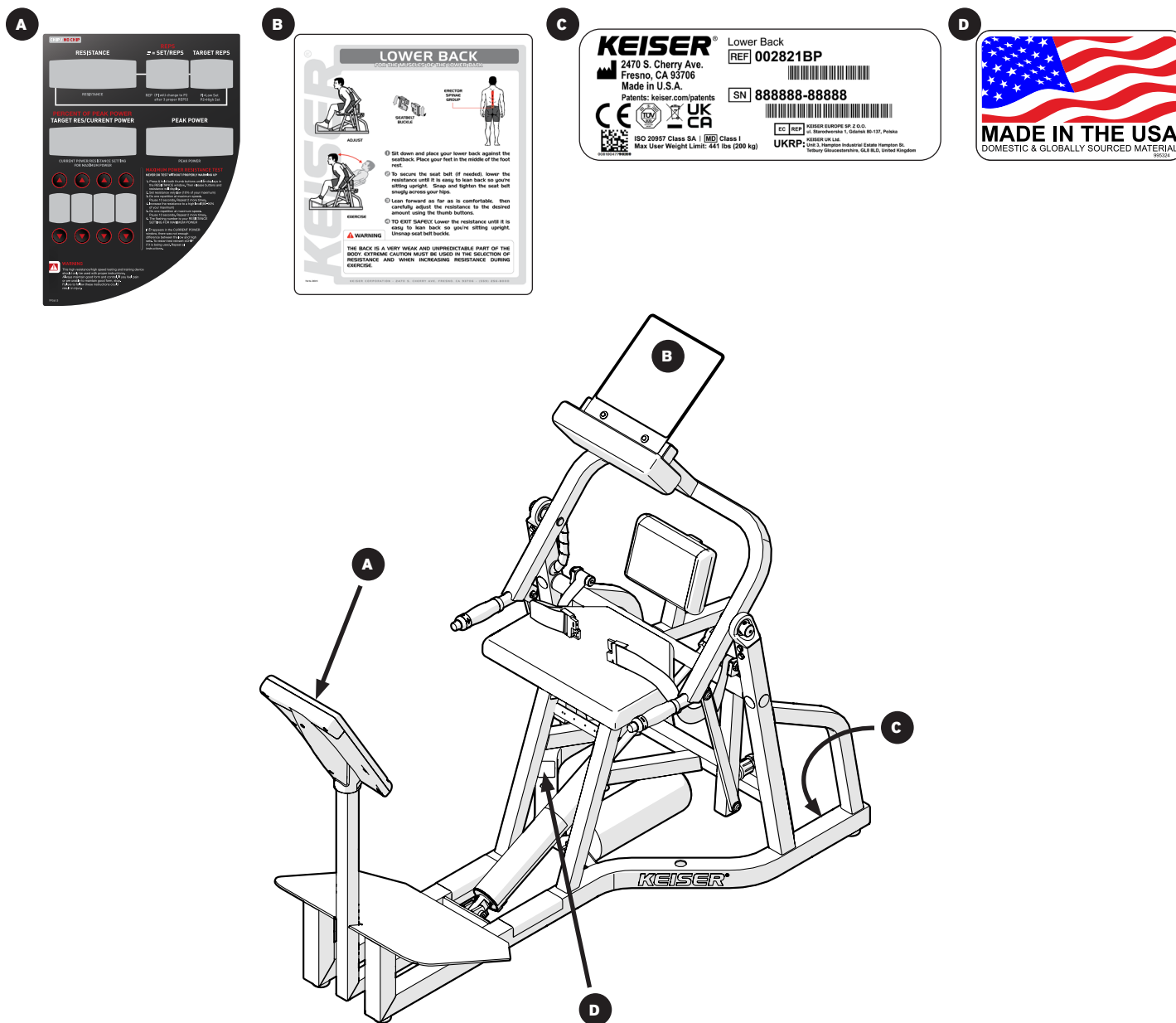

Maintain and do not remove safety or notification labels for any reason. They contain important information. If unreadable or missing, contact Keiser Corporation for a replacement (see back cover for contact information).

IMPORTANT SAFETY INFORMATION**CONTRAINDICATIONS**

There are a number of contraindications in the context of the relevant fields of the Lower Back use. In rehabilitation, only the medical staff can determine the form and extent of therapy. Medications can have an influence on the rehabilitation (e.g. neuroleptics, benzodiazepines, barbiturates, anti-epileptics, etc.). In the following cases, Lower Back training may only be carried out after consultation with a doctor:

- Pregnancy
- Acute thrombosis
- Fresh wounds (e.g. after surgery)
- Artificial joints or prosthetics
- Bone fractures
- Spinal disc damage
- Traumatic injury to the spine
- Diabetes
- Epilepsy
- Inflammation
- Acute migraine headache
- Chronic illnesses
- Cancer
- Acute myocardial infarction or unstable angina pectoris (determined by a stress test)
- Cardiovascular diseases e.g. severe high blood pressure at rest, carditis, congestive heart failure, severe valvular heart disease, dangerous heart arrhythmias at rest, or aortic aneurysm

If the patient is experiencing acute illness, febrile condition (i.e. fever), or newly occurring pain, this represents an absolute contraindication for physical stress. In such situations, it is necessary to postpone training until the patient's health has improved sufficiently.

In some situations (especially in patients with coronary heart disease or lung disease) overtraining can lead to an acute intensification of the patient's symptoms. In such situations, an exercise ECG is essential and training is only possible under medical supervision.

The use of the automated operation (pulse automatic, preset programs, external control via computer or other device) is prohibited, unless the strain was authorized by a physician in accordance with the patient's capacity/health.

For applications in endurance training, diagnostics and performance testing of patients, performance diagnostics, and stress tests, the same contraindications apply (among others) as with all physical stress. If there is doubt, it is important that a physician be consulted before using the Lower Back.

TECHNICAL SPECIFICATIONS

| Model Number | Device Full Description |
|--------------|-----------------------------|
| 002821BP | Lower Back, Black (color) |
| 002821SP | Lower Back, Special (color) |

EQUIPMENT SPECIFICATIONS

See Figure 2 for Lower Back dimensions and weight.

- Resistance Range 0 - 272 lbs (0 - 123 kg), change resistance in 1 lb/kg increments
- Maximum user weight limit:
441 lbs (200 kg)

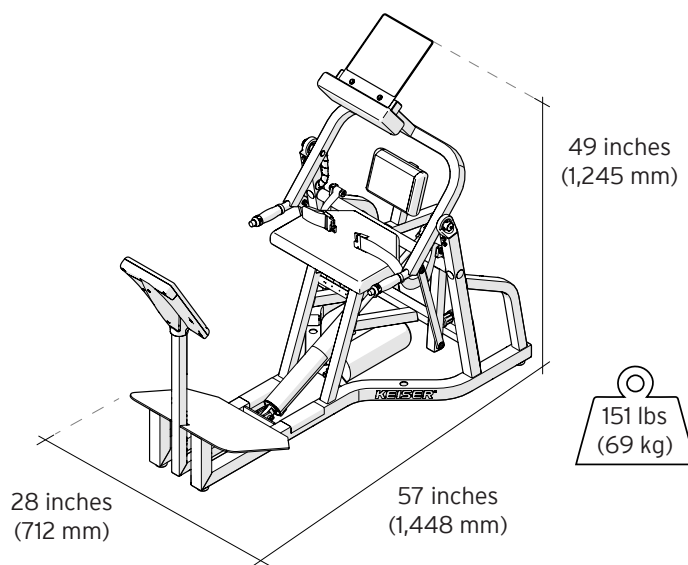

Figure 2. Lower Back Equipment Specifications

TECHNICAL DATA**AIR STORAGE TANK**

The equipment contains an air storage tank (air accumulator) with the following operating parameters:

| | |
|------------------------------|------------------------------|
| Maximum working pressure: | 125 psi (8.6 bar) |
| Maximum working temperature: | 104°F (40°C) |
| Minimum working temperature: | 32°F (0°C) |
| Maximum vessel capacity: | 144 in ³ (2.36 L) |

POWER

- 1.5V D Alkaline Batteries (quantity 2, Keiser PN 966500)
- 3V CR2032 Lithium Coin Cell Battery (quantity 1)
Permanently attached, not serviceable. Contact Keiser Customer Support for service.

INSTALLATION AND PLACEMENT

No assembly required. Place the Lower Back on a flat, level surface. Make sure the base of the frame makes full contact with the floor. If gaps are present, relocate the equipment to an even surface.

CONNECT THE EQUIPMENT TO THE KEISER AIR SYSTEM

⚠ WARNING: Never connect equipment to an air source capable of exceeding 120 psi / 8.27 bar. Over pressurizing Keiser pneumatic equipment may cause tubing to burst, breakage of equipment, abnormal operation, or serious injury. Use only clean, dry, regulated compressed air at the rated pressure range of 100-120 psi / 6.89-8.27 bar.

1. Plug the Compressor into the appropriate power source to power the Compressor ON (allow the Compressor to build up to a minimum of 100 psi / 6.89 bar; Keiser Compressor and Keiser Air System not included, sold separately).
2. Connect the 1/4-inch Quick Disconnect (QD) from the equipment into the Keiser Air Supply (see Figure 3).

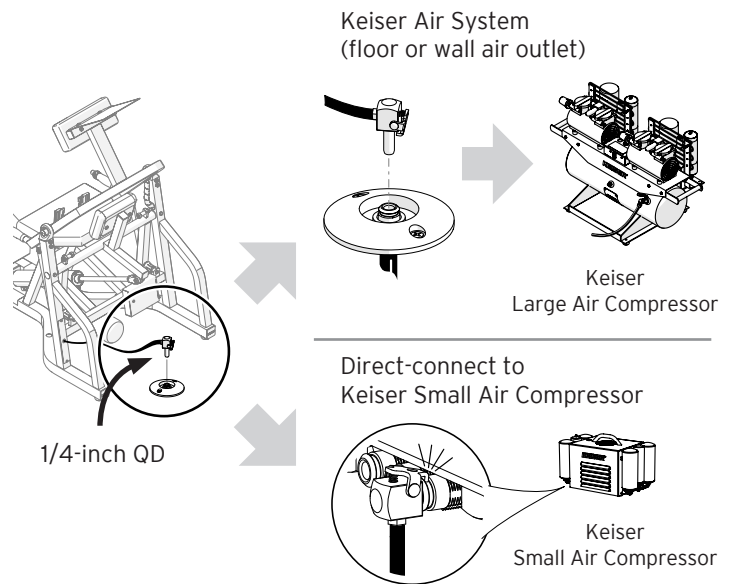

Figure 3. How to Connect the Equipment to the Keiser Air Supply

TRAINING SPACE

The equipment footprint is 57 inches x 28 inches (1,448 mm x 712 mm). The minimum recommended free space around the equipment is 24 inches (610 mm).

FOOTPRINT

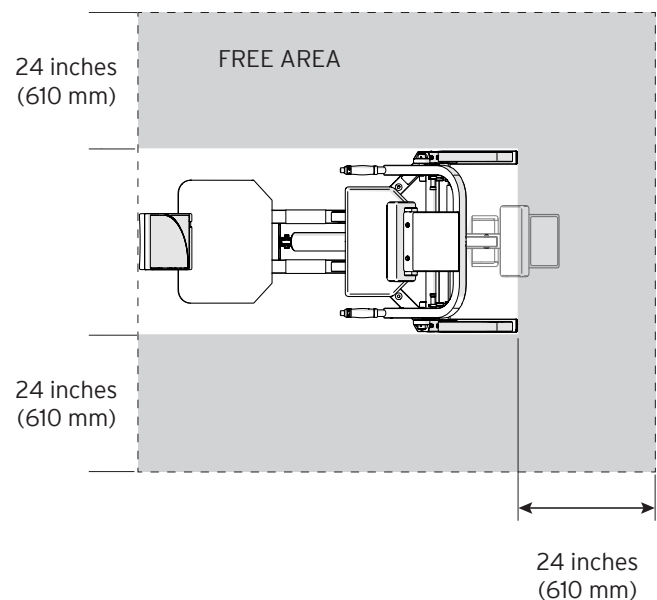
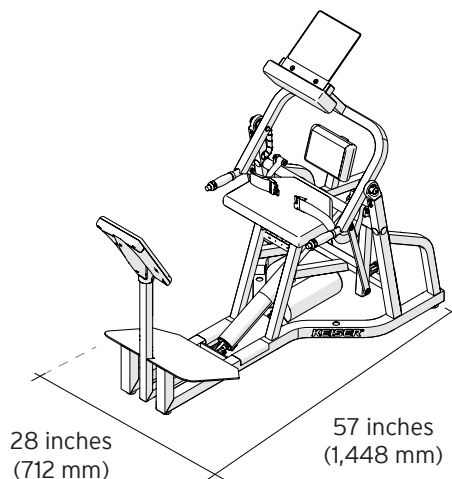

Figure 4. Training Space for the Lower Back

Note: Additional space at the rear may be required for taller users. Additional free space around all sides of the equipment may be required to accommodate mobility device access.

OPERATION

EQUIPMENT OVERVIEW



Figure 5. Lower Back

| | | | |
|---|---------------------------------------|----|---------------------------------|
| 1 | Upper Back Pad | 8 | Foot Plate |
| 2 | Exercise Arm | 9 | Anti-Slip Steps |
| 3 | Power Display | 10 | Cylinder |
| 4 | Seat Back | 11 | Air Tank |
| 5 | Seat Belt | 12 | Quick Disconnect (QD) with Tube |
| 6 | Increase/Decrease (+/-) Thumb Buttons | 13 | Processor Box |
| 7 | Seat | 14 | Instruction Placard (not shown) |

POWER DISPLAY

DISPLAY FEATURES

Resistance, Reps, and Power workout data output on the Power Display are shown below.



Figure 6. Power Display Overview

OPERATION

How to Adjust the Resistance

- Increase the resistance using the Positive “+” Thumb Button.
- Decrease the resistance using the Negative “-” Thumb Button.

How to Reset/Clear Workout Data (Reps, Percent of Peak Power, and Peak Power)

- Press and hold the Thumb Buttons simultaneously, release when “CLer” appears in the RESISTANCE window.
- eChip Users: “CLer” also deletes the current workout data from the eChip.

System Messages (appear in the RESISTANCE window)

- “OFF” = low-power consumption sleep mode.
Sleep mode occurs after 60 seconds of machine inactivity to help prolong battery life. To wake, press either Thumb Button and resume operation.
- “Lo-bA” (Low Battery) = weak batteries, replace soon.
If the batteries are dead (depleted), the Power Display remains blank. See page 17 “Battery Replacement” section for procedure.

POWER DISPLAY

POWER DISPLAY FEATURES WITH eCHIP

The Keiser eChip* is an optional digital workout log that records and recalls your workout data. Additional workout data made available when using the Power Display with an eChip are shown below.

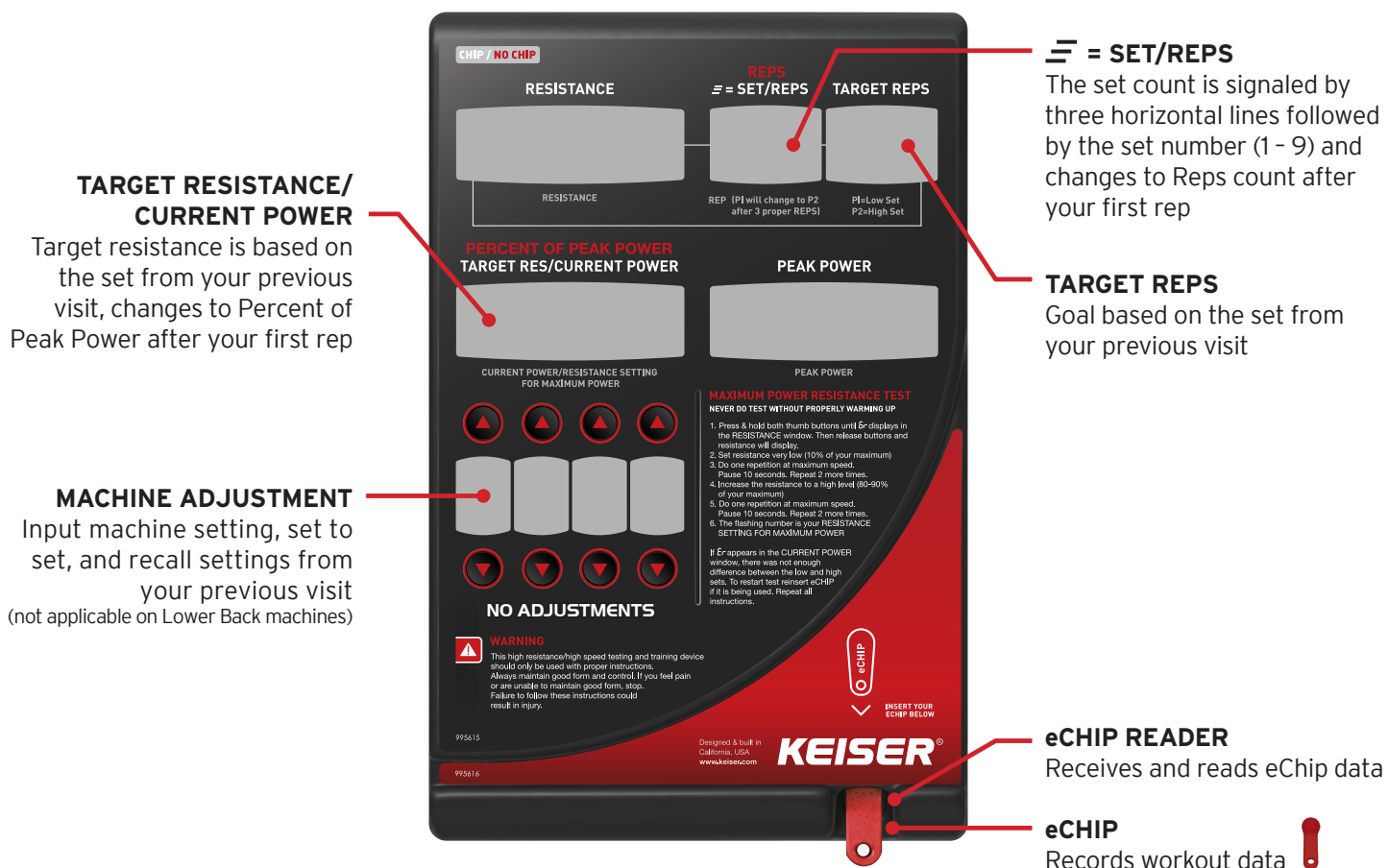

Figure 7. Power Display with eChip Overview

OPERATION

How to Record Workout Data on the eChip

1. Insert the eChip into the eChip Reader.
2. Prepare the machine for your workout:
 - Set the Resistance using the "+/-" Thumb Buttons.
3. Start your exercise:
 - Minimum 3 reps required to record a set.
 - Remove and re-insert the eChip to change Set number.

System Notes

- eChip Storage: Up to 24 machine models, up to 240 separate workout sets. Set count range is 1-9, rep count range is 0-99 per machine per visit. A visit is defined as multiple workouts that occur within a four-hour period.
- No workout data ("---") indicates the eChip was not previously utilized on the machine.
- Machine Adjustment: No Machine Adjustment data indicates no data was input to record. Settings can only be changed immediately after the eChip is inserted and before your third rep. After three reps are performed, the setting cannot be changed until the eChip is removed and reinserted. Settings are not saved in Power Tests (Keiser 6-Rep test) mode.

* eChip not included. Contact Keiser Customer Support for order information.

How to Recall Workout Data from the eChip

Insert eChip into the eChip Reader to recall workout data from the corresponding set of your previous visit:

- SET
- TARGET REPS
- TARGET RESISTANCE
- MACHINE ADJUSTMENT (not applicable)

PROPER OPERATION CHECK

Check equipment condition and function before every workout:

- A. **Thumb Buttons and Display** – press Thumb Buttons to check for proper “+ / -” operation and the Display powers on*.
- B. **Exercise Arm** – moves freely; no loose parts in the linkage system.
- C. **Upholstery and Seat Belt** – no excessive wear and are free of rips or tears; Seat Belt buckle functions properly.
- D. **Air Leaks** – no air leaks audible in the system.
- E. **Stability** – equipment is level to a solid, flat surface.

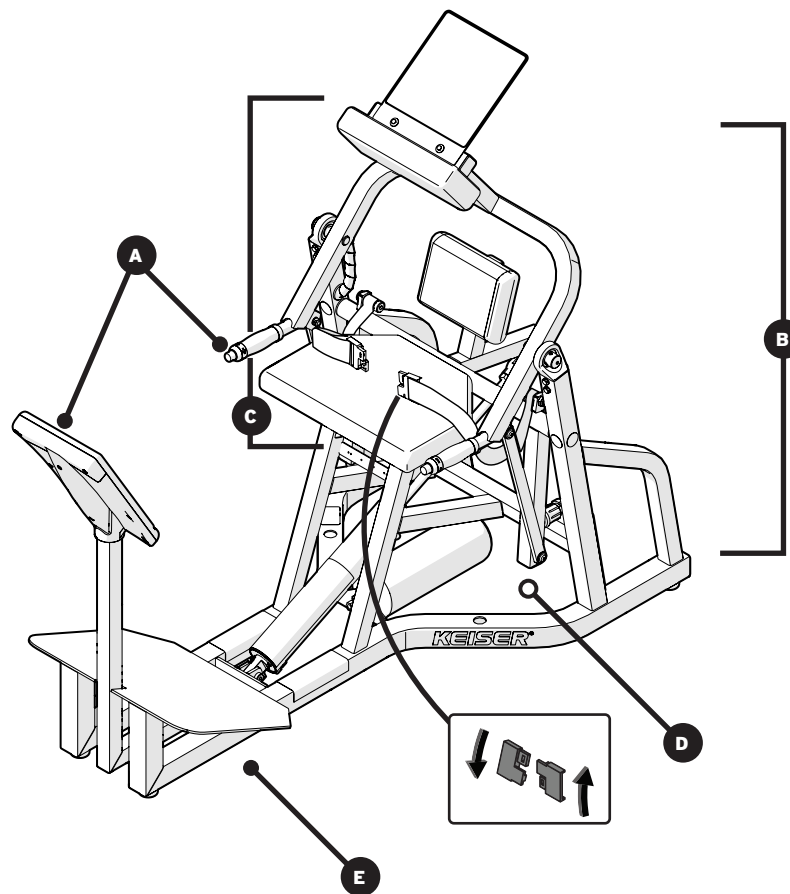

Figure 8. Proper Operation Check Illustration

Immediately replace damaged, worn, or broken parts. Do not use the Lower Back until all repairs have been completed and tested by a Keiser-certified technician.

* “Lo-bA” = Batteries are low, replace immediately. If batteries are dead (depleted), the Power Display remains blank (see Battery Replacement procedure, page 17).

HOW TO USE THE LOWER BACK

- 1 Sit down and place your lower back against the Seat Back. Place your feet in the middle of the Foot Rest.
- 2 To secure the Seat Belt (if desired), lower the resistance until it is easy to lean back so you are sitting upright. Snap the Seat Belt together and tighten the Belt snug across your hips.
- 3 Lean forward as far as is comfortable, then carefully adjust the resistance to the desired amount using the Thumb Buttons.
- 4 To exit safely, lower the resistance until it is easy to lean back so you are sitting upright. Unsnap the Seat Belt.

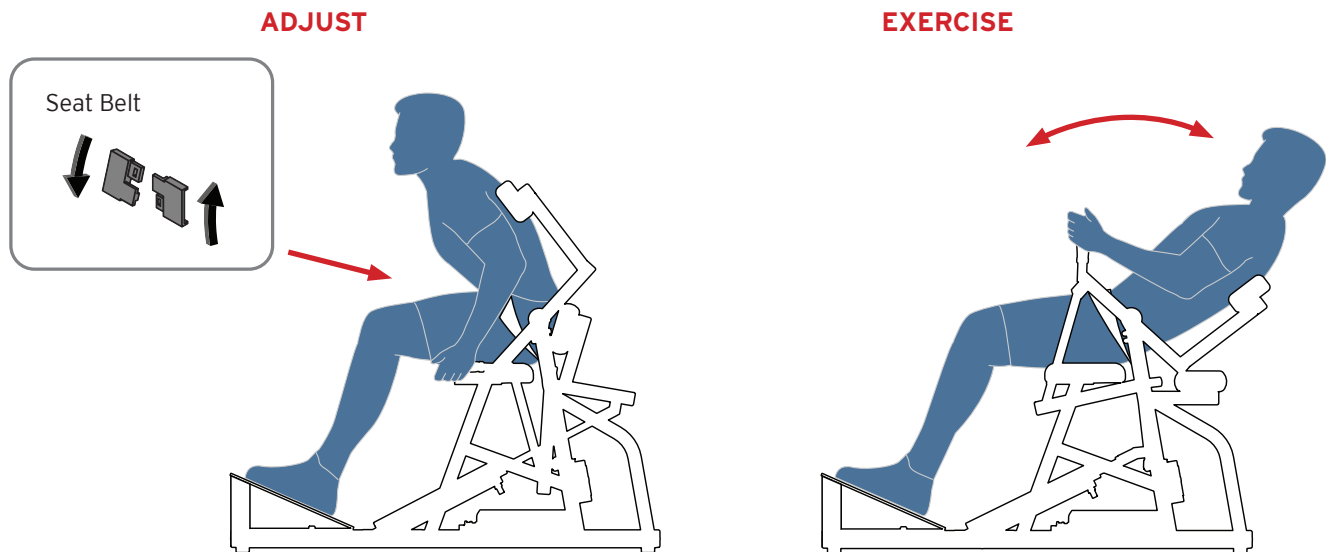

Figure 9. How to Use the Lower Back

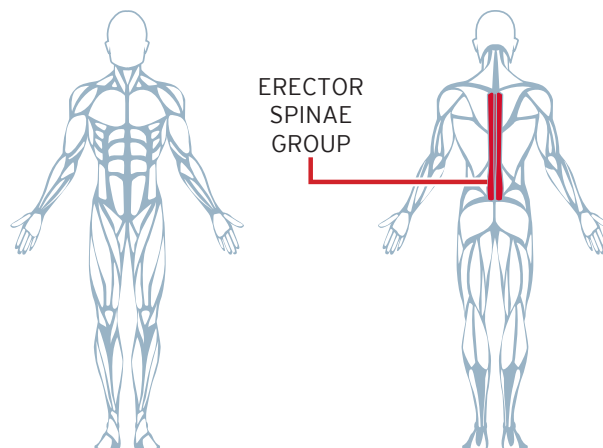

Figure 10. Lower Back Target Muscles

HOW TO USE THE LOWER BACK (CONTINUED)

⚠ CAUTION

- Consult your physician before beginning any exercise program.
- This equipment should only be used with proper instructions.
- Proper warm-up required to help prevent serious injury.
- Always maintain good form and control during exercise.
- If you feel pain, faintness, or are unable to maintain good form, stop immediately.
- Use caution when increasing/decreasing resistance during exercise.
- Never make adjustments to the machine during exercise. Failure to do so could result in serious injury.

CONCENTRIC PHASE (BACKWARD MOVEMENT)

- Holding the Handlegrips, extend backward using your low back for the movement.
- Keep your back in contact with the Upper Back Pad (Exercise Arm).

ECCENTRIC PHASE (FORWARD MOVEMENT)

- Return the Exercise Arm to the start position in a smooth, controlled manner.
- Slower speed during forward movement is recommended.
- Maintain control of the load; keep the Exercise Arm off the stops throughout the exercise.

BREATHING

- Exhale during the concentric phase (backward movement).
- Inhale during the eccentric phase (forward movement).

TRAINING TIPS

- Ensure your feet rest flat on the Foot Plate throughout exercise.
- Avoid rocking your body to create momentum when pushing heavy loads.

POWER TEST

⚠ CAUTION: Test should only be performed with proper instruction. Never perform Power Test without proper warm-up.

The purpose of the Power Test (KEISER 6-Rep Test) is to determine your RESISTANCE SETTING FOR MAXIMUM POWER. Use your RESISTANCE SETTING FOR MAXIMUM POWER as a baseline measurement to program safe and effective training sessions. The test consists of two sets:



Three repetitions
Low resistance, high speed
10% of your maximum



Three repetitions
High resistance, high speed
80-90% of your maximum

Speed is essential in power output. Perform all repetitions at maximum speed at the given resistance.

POWER TEST PROCEDURE

Before you begin: Warm-up and estimate your maximum resistance setting. During testing, you can adjust the resistance in either Set before rep "3" if needed (REPS resets to "0"). Note: Test may be performed with or without the eChip inserted.

1 START TEST

Press and hold both Thumb Buttons, release when "6 r" appears in the RESISTANCE window.

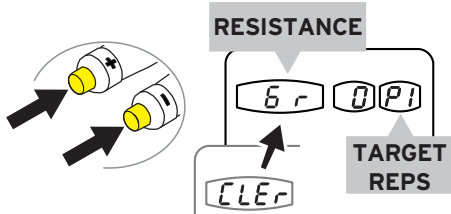

"P1" in the TARGET REPS window indicates Power Test, Set 1 initiated.

2 SET RESISTANCE, LOW LEVEL

Set the resistance to a low level (10% of your maximum).

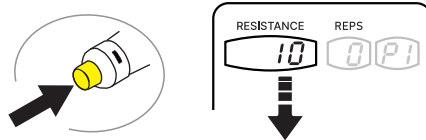
**3 POWER TEST, SET 1 ("P1")**

Perform one repetition at maximum speed. Pause briefly, then perform two repetitions at maximum speed.

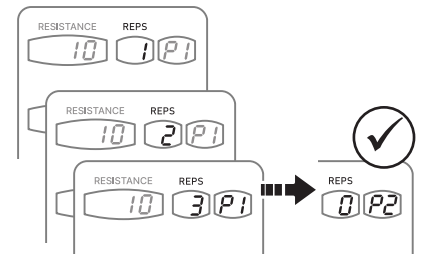

Note: Test advances to "P2" (Power Test, Set 2).

4 SET RESISTANCE, HIGH LEVEL

Increase the resistance to a high level (80-90% of your maximum).

**5 POWER TEST, SET 2 ("P2")**

Perform one repetition at maximum speed. Pause briefly, then perform two repetitions at maximum speed.

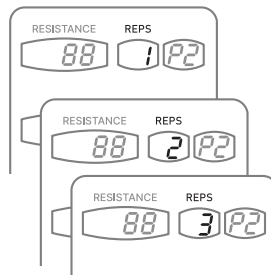
**6 TEST RESULT**

After your last rep, your **RESISTANCE SETTING FOR MAXIMUM POWER** value is displayed.

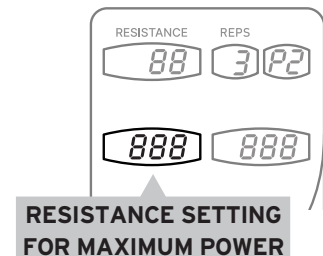

TEST COMPLETE. Exit Power Test to resume normal operation.

How to exit the Power Test: Press and hold the Thumb Buttons simultaneously, release when "CLER" appears in the RESISTANCE window (eChip users: Remove the eChip).

Troubleshoot: "Er" 1 - 4 indicates not enough difference in resistance between the low and high sets. Try again with a greater difference in resistance between the low and high sets. To restart the Power Test at any time, begin at Step 1 (eChip users: Remove and reinsert the eChip before attempting to restart the test).

MAINTENANCE



CAUTION: SERVICE AND REPAIR SHALL ONLY BE PERFORMED BY KEISER-CERTIFIED TECHNICIANS.
Failure to follow these instructions can result in serious injury.

PREVENTATIVE MAINTENANCE SCHEDULE



CAUTION: THE HIGHEST LEVEL OF EQUIPMENT SAFETY CAN ONLY BE ENSURED IF THE EQUIPMENT IS REGULARLY INSPECTED FOR DAMAGE AND WEAR. Immediately replace damaged, worn, or broken parts. Do not use the Lower Back until all repairs have been completed and tested by a Keiser-certified technician.

| | |
|---|--|
| Daily | <ul style="list-style-type: none"> • Check for safe and proper function of the equipment (perform "Proper Operation Check," page 12). • Clean the chrome and paint where applicable. • Clean the upholstery: Wipe down with a clean cloth. If necessary, use water and mild soap (neutral, non-caustic). Target areas that come in contact with sweat. Wipe dry the equipment. |
| Weekly | <ul style="list-style-type: none"> • Check parts most susceptible to wear are not damaged or broken: <ul style="list-style-type: none"> - Upholstery, Seat Belt, Linkage System, Thumb Buttons, and Hand Grips. • Wax chrome and paint where applicable; wax upholstery. • Clean Hand Grips • Inspect Air Line Filter. |
| Monthly | <ul style="list-style-type: none"> • Check externally visible nuts and bolts are properly fastened with no looseness. • Clean and lubricate Cylinder Rod. • Inspect Air Line for kinks, tears, or breaks. • Inspect Frame for any weakening in weld areas, and other connected areas. |
| Quarterly | <ul style="list-style-type: none"> • Lubricate Pivot Bushings. • Inspect Exhaust Muffler and Air Filter for discoloration; replace if necessary. • Verify compressor(s) cycle on/off between 100-120 psi (6.89-8.27 bar). |
| Annually and other Required Maintenance | <ul style="list-style-type: none"> • For complete instructions, see page 18 "Annual Maintenance." • Battery Replacement. The low battery signal ("Lo-bA") will appear on the Power Display when it is time to replace the batteries. Refer to page 17 "Battery Replacement" for complete instructions. <p>NOTE: Your Keiser Air Compressor (not included with your Lower Back) requires basic annual maintenance. Contact Keiser Customer Support for Air Compressor operator manual or download at keiser.com/support (search: Air Compressor manuals).</p> |

❗ IMPORTANT: Do not use household or industrial cleaners as they contain caustic chemicals that can destroy the paint finish and cause corrosion. Use only mild soap/detergent (neutral, non-caustic) to clean.

Contact Keiser Customer Support for replacement parts order, or for any matters regarding the safe operation of your Lower Back (see back cover for contact information).

BATTERY REPLACEMENT

Do not operate the equipment during battery replacement procedure. "Lo-bA" = Batteries are low, replace immediately. NOTE: If batteries are dead (depleted), the Power Display remains blank. To replace the batteries, refer to Figure 11 and follow the instructions below (no tools required).

1. Unscrew the Brass Nut on the Processor Box. Pull and remove the cover.
2. Remove the 2 D batteries by carefully pulling out the Battery Sleeve (follow manufacturer's recommendations for handling, maintaining, and disposing of batteries).
3. Observe the correct polarity position (see +/- marking inside the battery compartment), insert the 2 new D batteries into the battery sleeve and install.
 - The Power Display will enter a brief test sequence (you will see a series of numbers flashing).
4. Replace the Processor Box cover and screw the Brass Nut finger tight.

❗ IMPORTANT: Once the test sequence ends (numbers stop flashing), press either the increase or decrease Thumb Button and allow the machine to enter sleep mode ("OFF") to resume normal operation.

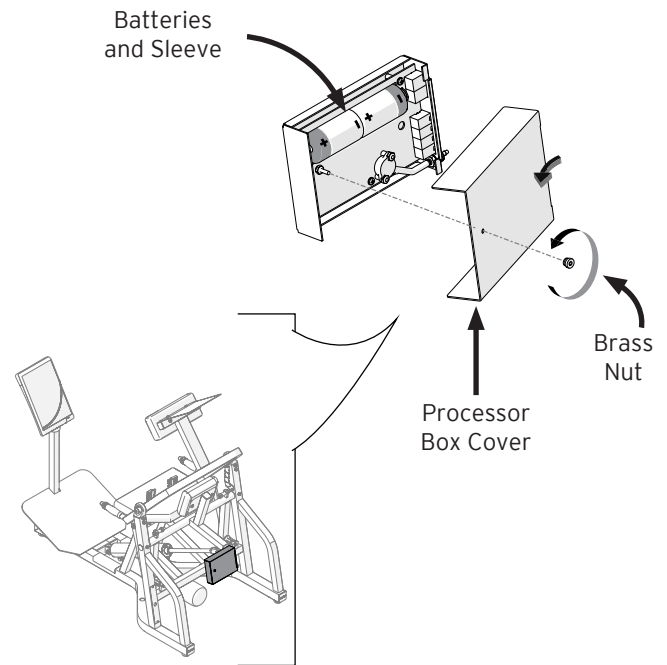

Figure 11. Battery Replacement

⚠ CAUTION

Do not dispose of batteries in a fire. The batteries may explode.

Do not open or mutilate batteries. They contain an electrolyte which is toxic and harmful to the skin and eyes.

Replace batteries with the same number and type of batteries as originally installed in the equipment.

Recycle batteries in accordance with local recycling procedures.

ANNUAL MAINTENANCE

The following routine maintenance is recommended annually or at the time batteries are replaced:

- 1 Clean:
 - Wipe any accumulated dust around the Frame and the Linkage System, including the Air Tank and Cylinder, using a clean shop cloth.
- 2 Visual inspection of the Exercise Arm and Linkage System:
 - Move freely and no loose parts. Ensure Pivot Bushings are lubricated; all externally visible nuts and bolts are properly tightened.
- 3 Visual inspection of Air Lines and Communication Wires:
 - Air Lines have no kinks, tears, or breaks; Communication Wires have no exposed wires or visible damage.
- 4 Replace the Muffler if discoloration is present:
 - Tool required: 11/16 inch Wrench or Adjustable Wrench.
- 5 Replace the Air Filter if element is dirty (element turns a bright pink or red color):
 - Tools required: Small Needle Nose Pliers, Cutter Tool (to cut off flared end of tubes).
- 6 Lubricate Cylinder Rod:
 - Wipe the Cylinder Rod clean and coat lightly with clean, SAE 30 motor oil, or with a silicon-based spray.

⚠ WARNING: HIGH-PRESSURE AIR. DISCONNECT THE EQUIPMENT FROM THE AIR SUPPLY AND RELEASE ALL THE AIR IN THE EQUIPMENT ("–" THUMB BUTTON) BEFORE PERFORMING ROUTINE MAINTENANCE.

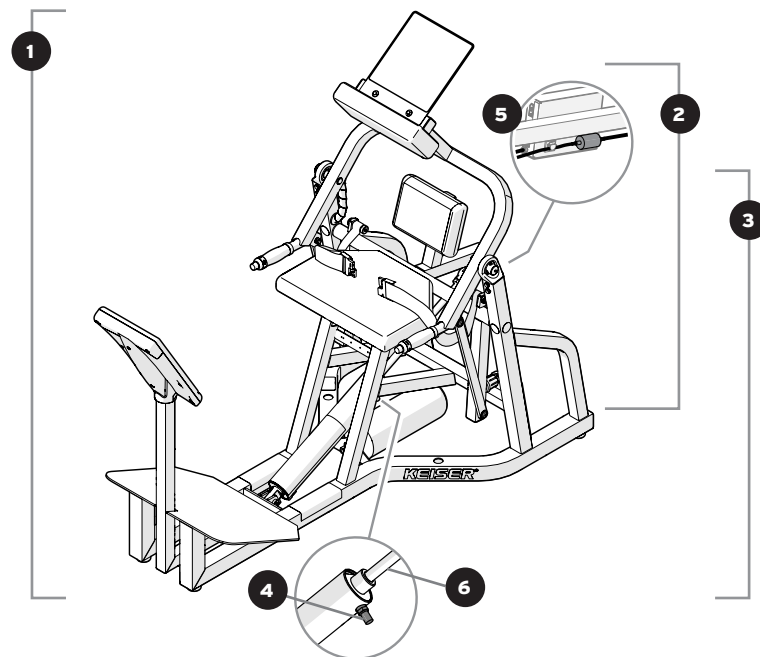
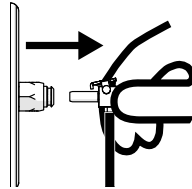





Figure 12. Annual Routine Maintenance Illustration

Contact Keiser Customer Support for replacement part(s) order, or for any matters regarding the safe operation of your Lower Back (see back cover for contact information).



REGULATORY AND COMPLIANCE NOTICES

| | |
|-----------|---|
| Standards | ISO/EN 20957-1 Accuracy Class A (High accuracy) and Usage Class S (Studio, commercial use); IEC/EN 60601-1 and IEC/EN 60601-1-2. |
| Marks |     |

SAFETY NOTIFICATIONS

Displayed watts testing parameters: “Current Power,” “Peak Power,” and “Percent of Peak Power” are not suitable for use in applications where the health and safety of a patient may be dependent on the accuracy of those parameters.

Clinical Settings Note: In clinical settings, patients may operate this equipment in accordance with this user manual and the instructions and guidance provided by the healthcare personnel responsible for supervising their treatment and care. However, patients shall not perform preventive maintenance, repairs or replace batteries on equipment installed in clinical facilities.

| TYPE/DEGREE OF PROTECTION | CLASSIFICATION/IDENTIFICATION/WARNINGS | SYMBOL |
|--|--|---|
| The degree of protection against electric shock | Device is powered by two D cell alkaline batteries. Electrical safety evaluation conducted by TÜV SÜD per IEC/EN 60601-1 requirement. |  |
| The degree of protection against the ingress of liquids | Not protected | N/A |
| The degree of safety in the presence of a flammable anesthetic mixture with air or with oxygen or nitrous oxide | Not suitable | N/A |
| The mode of operation | Continuous | N/A |
| Information regarding potential electromagnetic or other interference and advice regarding avoidance | The Lower Back use electromagnetic and RF energy only for its internal function. Therefore, its EMC and RF emissions are very low and are not likely to cause any interference in nearby electronic equipment. | N/A |
| EMC Notices, Statement of Compliance | See Electromagnetic Compatibility (EMC) section, page 20. | N/A |
| ID of specified optional external power supplies or battery chargers | The Lower Back does not require an external power supply. | N/A |
| ID of any risks associated with the disposal of waste products, residues, including disposal of the equipment itself at the end of its useful life | The Lower Back contains electronic circuit assemblies, 2 alkaline D cell batteries, and a sealed lithium coin cell battery that may require compliance with specific local disposal or recycling procedures. |  |
| The specification of the environmental conditions of transport and storage | Use indoor in climate-controlled environment only. Keep away from areas of extreme humidity. NOTICE: Equipment not tested at extreme high/low temperatures. | N/A |

ELECTROMAGNETIC COMPATIBILITY (EMC)

EMC Notices – Statement of Compliance

This product has been determined to be compliant with the applicable standards, regulations, and directives for the countries where the product is marketed.

Compliance documentation, such as Declaration of Compliance for the product, are available upon request by contacting service@keiser.com. Please include the product, model number identifiers, and serial number and country that compliance information is needed for in request.

Korea

이 기기는 가정용(B급)으로 전자파적합등록을 한 기기로서 주로 가정에서 사용하는 것을 목적으로 하며, 모든 지역에서 사용할 수 있습니다.

"This equipment is for home use and has acquired electromagnetic conformity registration, so it can be used not only in residential areas but also other areas."

US FCC COMPLIANCE STATEMENT

NOTE: This equipment has been tested and found to comply with the limits for a Class B digital device, pursuant to part 15 of the FCC Rules. These limits are designed to provide reasonable protection against harmful interference in a residential installation. This equipment generates, uses and can radiate radio frequency energy and, if not installed and used in accordance with the instructions, may cause harmful interference to radio communications. However, there is no guarantee that interference will not occur in a particular installation. If this equipment does cause harmful interference to radio or television reception, which can be determined by turning the equipment off and on, the user is encouraged to try to correct the interference by one or more of the following measures:

- Reorient or relocate the receiving antenna.
- Increase the separation between the equipment and receiver.
- Connect the equipment into an outlet on a circuit different from that to which the receiver is connected.
- Consult the dealer or an experienced radio/TV technician for help

DISPOSAL

DISPOSAL



This equipment contains electrical or electronic components, alkaline batteries, and a sealed lithium coin cell battery that must be disposed of properly to comply with the EU Directive on disposal of waste electrical and electronic equipment (EU WEEE Directive 2002/96/EC).

Contact an appropriate waste disposal company upon the equipment's end of service life. Disposal must be in accordance with respective national regulation.

Wear parts: After being replaced, wear parts must be disposed of according to country-specific waste laws.

If you have any questions about equipment disposal, please contact your local dealer or Keiser Customer Support (see back cover for contact information).

This page intentionally left blank.

This page intentionally left blank.

WARRANTY STATEMENT

View or print your Lower Back warranty online at keiser.com/support/warranty.

If you have any questions about your warranty, please contact Keiser Customer Support at 1 559 256 8000 and via live chat at keiser.com/support (Monday–Friday, 7 am to 5:30 pm PST), or by email at service@keiser.com.

Customers outside the United States may obtain warranty information directly through a Keiser international distributor or dealer in the country of installation, or direct from Keiser's international division.

European Authorized Representative



KEISER EUROPE SP. Z O.O.

ul. Starodworska 1
Gdańsk 80-137
Polska

UK Responsible Person (UKRP)

KEISER UK Ltd.

Unit 3, Hampton Industrial Estate
Hampton St., Tetbury
Gloucestershire, GL8 8LD
United Kingdom

CUSTOMER SUPPORT

If you have any questions regarding the operation of the Lower Back after reading this manual, contact Keiser Customer Support:

 1 559 256 8000

 service@keiser.com

 keiser.com/support

Telephone and Live Chat
Monday–Friday 7 am to 5:30 pm PST

Manufactured in the USA

KEISER CORPORATION

 2470 S. Cherry Ave.
Fresno, CA 93706